



Technical specifications

Intended use	Endodontics				
Indications for use	Non-surgical endodontic retreatment.				
Description	Long retreatment tip for the retreatment of very hard materials in the middle third				
Tip type	Smooth				
Allergenic factor	Tip made of surgical stainless steel as per ASTM F899 - 12b				
	Surgical stainless steel contains: <ul style="list-style-type: none">• nickel• chromium				
Commercial reference	ET40D : F88014				
Medical class	Class of medical device: IIa according to 93/42/EEC directive				
Adjustments	Newtron range	P5 Range	Suprasson P5 Booster	Prophy Max - P-Max - Implant Center 2 - Piezotome 2	Irrigation
	7	7	5	3	

Service life

As it is not possible to establish a maximum number of uses (that may be determined by many parameters such as duration of use, hardness of enamel, the force applied, wear), we recommend that medical devices being routinely used are replaced at least once a year. Replace the medical device if the tip does not vibrate at the expected frequency, the treatment is not progressing as normal and is taking longer or is at a standstill.

Associated documentation

Document title	References
Consulting electronic user instructions	J00007
Cleaning, disinfection and sterilization instructions for tips	J02001
Files - ET40 clinical tips	J08041
Ultrasonic generator power settings table	J58000
General instructions relating to the complete range of standard ultrasonic dental tips	J02101

Sterilization



Sterilize prior to each use

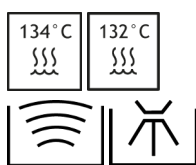

The tips must be cleaned, disinfected and sterilized prior to each use. Prior to each use, please refer to the cleaning, disinfection and sterilization instructions for tips J02001.

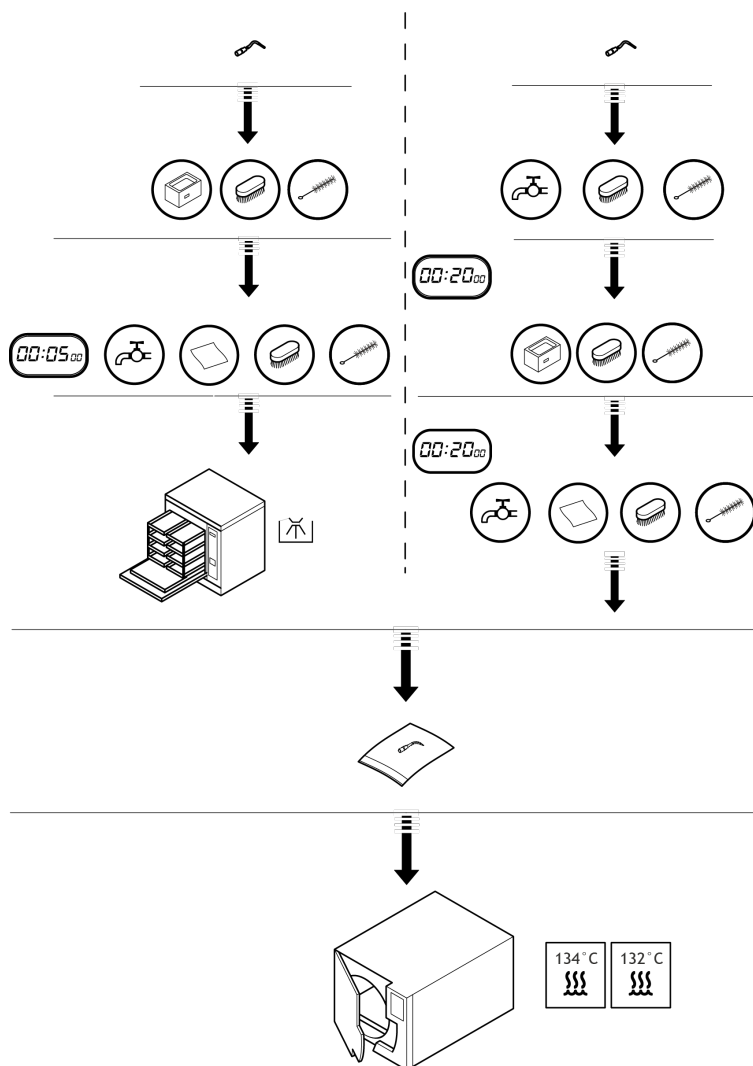

Installation

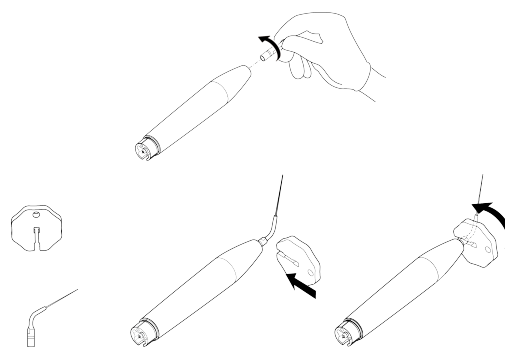

Disassembly

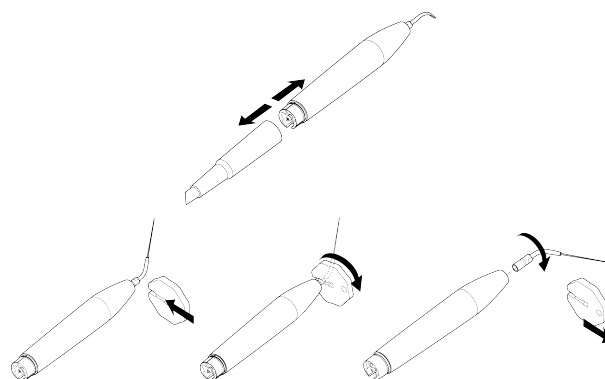
**Manufactured For:**

EdgeEndo
5600 Wyoming Blvd NE
Suite 100
Albuquerque, NM 87109

www.edgeendo.com



Date of first CE marking

1998

Tip | ET40D | J00761 | (98) | V1 | 03/2017 | NB26EN130A

SATELEC S.A.S. | A Company of ACTEON Group
17 av. Gustave Eiffel | BP 30216 | 33708 MERIGNAC cedex | FRANCE
Tel. +33 (0) 556 34 06 07 | Fax. +33 (0) 556 34 92 92
E-mail: satelec@acteongroup.com | www.acteongroup.com