

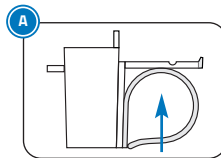

EndoRing® II

⚠ Instructions for Use



A. Before assembly, choose one of three ring sizes (small, medium or large) that best fits your index finger. Slide the selected ring into the cup channel located beneath the scale.

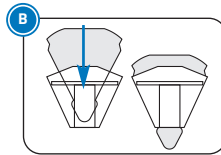

B. Place the EndoRing e-Foam insert into the EndoRing cup. Pull the e-Foam insert out the bottom of the cup to seat the foam.

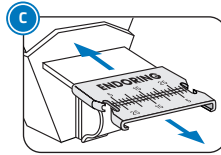

C. Prior to first use, steam autoclave the EndoRing cup with the metal ruler attached to the ruler platform. After the first autoclaving, the metal ruler will easily slide on and off the EndoRing cup. For subsequent autoclaving, always remove the metal ruler from the ruler platform. **WARNING:** If the metal ruler gets loose, remove it and steam autoclave process the EndoRing cup for 2 cycles to restore the retention feature.

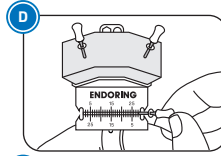

D. Arrange hand files, rotary files or other instruments, such as Gates Gliddens, into the e-Foam insert. Remove all file bioburden prior to autoclaving files in the e-Foam insert. When using rubber stops, utilize the stop locks on either the built-in ruler or the detachable metal ruler to increase or decrease the instrument's working length. The rulers perform well with paper points, gutta percha and many other endodontic instruments. To efficiently clean instruments, simply pass them in and out of the e-Foam insert. You can also clean instruments by sliding them through the corrugated area on top of the e-Foam insert. Rubber stops can be safely added to instruments using the ports located on the back of the EndoRing cup.

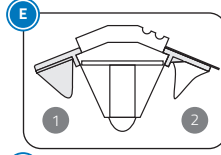

E. GelWell attachments can be placed onto the EndoRing cup to hold Jordco's EndoGel® lubricant or other lubricating gels and liquids. Use either the reusable 2.0ml cup (1) or the single-use clear .65ml cup (2) inserted into the attachment ring. These can be reversibly attached to either side of the EndoRing cup.

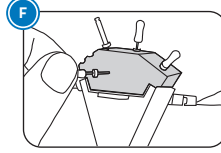

F. The back of the EndoRing cup features the Endo Docking Station™. When held by an assistant, a doctor operating under a surgical microscope, can safely pass files into the expanded area of e-Foam. The area is also ideal for storing used files.

Processing Instructions

EndoRing Cup with Finger Ring	Pre-cleaning Instructions: Disassemble the metal ruler (if equipped) and any GelWell cups or rings. Rinse all items under tap water to remove gross and visible soils. Use a scrub brush if necessary to remove visible soils. Place items in an ultrasonic bath with only an enzymatic detergent prepared to the manufacturer's directions. Fully immerse the items and soak for 1 minute. Then sonicate the parts for 5 minutes and remove and rinse for 15 seconds with tap water. Inspect for any soils and repeat if any soils are visible.
GelWell Cup	
GelWell Adaptor Ring	Steam Autoclave Processing Instructions: Place items in an FDA approved autoclave pouch/bag. Using a steam autoclave, process the items at 250°F (121°C) for 30 minutes. Allow the bagged articles to dry for 30 minutes. During steam autoclave processing, place all components near center of the chamber. Do not exceed temperature of 275°F (135°C).
Metal Ruler (if equipped)	
Single Use e-Foam Inserts	Steam autoclave process a new e-Foam insert prior to use. Unused or ultrasonically cleaned files may be placed in the e-Foam insert prior to processing. Autoclaving will not remove bioburden left behind from prior usage. The e-Foam insert, along with files, may be placed in an FDA approved autoclave pouch/bag prior to processing. Do not exceed temperature of 275°F (135°C). To avoid deforming the e-Foam insert, do not load or stack items on top of the e-Foam insert during autoclave processing. Dispose of after each use.
Single Use GelWell Cups	Always use a new single use GelWell cup for each procedure. Do not autoclave the cups because they will deform and or melt. Dispose of after each use. To disinfect, always use an FDA approved High Level Disinfectant and follow the manufacturer's instructions.

Warning: Do not place any components into Surgical Milk, "cold sterilizing solutions" or instrument dips prior to autoclave processing. Only use enzymatic ultrasonic detergents when pre-cleaning the EndoRing cup and the metal ruler in ultrasonic cleaners. (1804)

Symbols Glossary Available at: www.jordco.com/symbols

Jordco products are covered by one or more U.S. or foreign patents or patent applications owned by Jordco, Inc. of Beaverton, OR, USA. See www.jordco.com for details. JORDCO, ENDORING, E-FOAM, ENDOGEL, E-DX, and FILECADDY are trademarks of Jordco, Inc., registered in the United States and/or other countries. The blue color of the e-Foam inserts and the endodontic organizer, the yellow color of the e-Foam inserts, and the colors yellow and blue-yellow together on e-Foam insert packaging, are all trademarks of Jordco, Inc., registered in the United States. See the above website for further information. (1704)

REV1903

